

## Operator's Instruction Manual & Parts List

# EDCO 36" CORE DRILL



**Manual - Portable**

## READ AND UNDERSTAND THE OPERATORS INSTRUCTION MANUAL THOROUGHLY BEFORE ATTEMPTING TO OPERATE THIS EQUIPMENT.



**Death or serious injury could occur if this machine is used improperly.**



### SAFETY MESSAGES

- Safety Instructions are preceded by a graphic alert symbol of DANGER, WARNING, or CAUTION.

#### DANGER

Indicates an imminent hazard which, if not avoided, will result in death or serious injury.

#### WARNING

Indicates an imminent hazard which, if not avoided, can result in death or serious injury.

#### CAUTION

Indicates hazards which, if not avoided, could result in serious injury and or damage to the equipment.

### GASOLINE/PROPANE POWERED EQUIPMENT

#### WARNING

- Engine exhaust from this product contains chemicals known to the State of California to cause cancer, birth defects or other reproductive harm.



- Gasoline is extremely flammable and poisonous. It should only be dispensed in well ventilated areas, and with a cool engine.

- Small gasoline engines produce high concentrations of carbon monoxide (CO) example: a 5 HP 4 cycle engine operation in an enclosed 100,000 cu. ft. area with only one change of air per hour is capable of providing deadly concentrations of CO in less than fifteen minutes. Five changes of air in the same area will produce noxious fumes in less than 30 minutes. Gasoline or propane powered equipment should not be used in enclosed or partially enclosed areas. Symptoms of CO poisoning include, headache, nausea, weakness, dizziness, visual problems and loss of consciousness. If symptoms occur - get into fresh air and seek medical attention immediately.

### ELECTRICAL POWERED EQUIPMENT



Extreme care must be taken when operating electric models with water present: Ensure power cord is properly grounded, is attached to a Ground-Fault-Interrupter (GFI) outlet, and is undamaged.

- Check all electrical cables - be sure connections are tight and cable is continuous and in good condition. Be sure cable is correctly rated for both the operating current and voltage of this equipment.
- Improper connection of the equipment-grounding conductor can result in a risk of electric shock. Check with qualified electrician or service person if there is any doubt as to whether the outlet is properly grounded. Adhere to all local codes and ordinances.
- **NOTE:** In the event of a malfunction or breakdown, grounding provides a path of least resistance for the electric current to dissipate. The motor is equipped with a grounded plug and must be connected to an outlet that is properly installed and properly grounded. DO NOT modify the plug provided on the motor. If the plug does not fit the outlet have a qualified electrician install the proper receptacle.
- Switch motor OFF **before** disconnecting power.

- Do not disconnect power by pulling cord. To disconnect, grasp the plug, not the cord.
- Unplug power cord at the machine when not in use and before servicing.

### GENERAL INSTRUCTIONS

- Equipment should only be operated by trained personnel in good physical condition and mental health (not fatigued). The operator and maintenance personnel must be physically able to handle the bulk weight and power of this equipment.
- This is a one person tool. Maintain a safe operating distance to other personnel. It is the **operators' responsibility** to keep other people (workers, pedestrians, bystanders, etc.) away during operation. Block off the work area in all directions with roping, safety netting, etc. for a safe distance. Failure to do so may result in others being injured by flying debris or exposing them to harmful dust and noise.
- This equipment is intended for commercial use only.
- For the operator's safety and the safety of others, always keep all guards in place during operation.
- Never let equipment run unattended.



- Personal Protection Equipment and proper safety attire must be worn when operating this machinery. The operator must wear approved safety equipment appropriate for the job such as hard hat and safety shoes when conditions require. Hearing protection **MUST** be used (operational noise levels of this equipment may exceed 90db). Eye protection **MUST** be worn at all times.



Keep body parts and loose clothing away from moving parts. Failure to do so could result in dismemberment or death.

- Do not modify the machine.
- Stop motor/engine when adjusting or servicing this equipment.



Maintain a safe operating distance from flammable materials. Sparks from the cutting-action of this machine can ignite flammable materials or vapors.

### DUST WARNING

#### WARNING

Some dust created by power sanding, sawing, grinding, drilling, and other construction activities contains chemicals known to cause cancer, birth defects, or other reproductive harm. Some examples of these chemicals are:

- Lead from lead-based paints, and
- Crystalline silica from bricks and concrete and other masonry products.

Your risk of exposure to these chemicals varies depending on how often you do this type of work. To reduce your risk: work in a well ventilated area, use a dust control system, such as an industrial-style vacuum, and wear approved personal safety equipment, such as a dust/particle respirator designed to filter out microscopic particles.

# SPECIFICATIONS

## Table of Contents

<u>Section</u>	<u>Page Number</u>
Safety Instructions.....	2
Specifications.....	3
Safety Guidelines.....	4
Securing Instructions.....	5
Drilling Instructions.....	5
Preventative Maintenance.....	6
SMI Dust and Silica Warning.....	6
Parts Lists.....	7-8
Core Drill Illustrations.....	9-11
Limited Equipment Warranty.....	Back Page

Note:  
All dimensions and weights are for **reference only** and subject to change at any time.

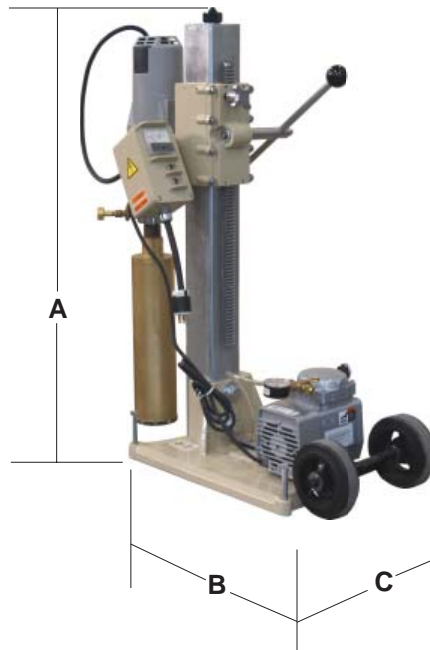

**Figure 1**

### HOW TO ORDER REPAIR PARTS

To insure product safety and reliability, always use genuine EDCO replacement parts when making repairs to the equipment.

When ordering parts, please specify the MODEL and SERIAL NUMBER of the machine as given on the NAMEPLATE. In addition, give part number, description and quantity as listed on the parts list.

Please note: Due to improvements and changes in the equipment the illustrations shown may be different from the actual machine.

Toll Free: Phone 1-800-638-3326 • Fax 1-800-447-3326

	<b>36" CORE DRILL</b>
"A"	36" (91.44mm)
"B"	24.5" (62.23mm)
"C"	14" (35.56mm)
Weight	159 lbs. (72.1kg)



100 Thomas Johnson Drive, Frederick, MD 21702-4600 USA  
 Phone (301) 663-1600 • 1-800-638-3326  
 Fax (301) 663-1607 • 1-800-447-3326  
 Website: www.edcoinc.com  
 Email: sales@edcoinc.com

Printed in USA

©2009

**Page 3**



Read and understand this *Operator's Instruction Manual*,  
and the *Engine Manufacturer's Owner's Manual*  
**before** operating this equipment.



Death of serious injury can result if this machine is used improperly.



## Safety Guidelines



Eye and ear protection must be worn at all times while the drill is in use. During normal operation, sound pressure levels may exceed 92dBA. Use only ANSI approved safety glasses to help prevent eye injury. Standard eyeglasses have only impact resistant lenses; they are NOT safety glasses.



Operator must wear appropriate clothing and footwear. Do not wear loose clothing or jewelry that can get tangled in moving parts. Footwear should provide sure footing and protection from debris that may be dropped. Take steps to insure hair will not be caught in moving parts. If necessary, tie it back.

- When loading or unloading the drill, use caution. Make sure carriage is locked so that the blade will not be damaged. Do not move the drill while the motor is running.
- Never exceed the maximum operating speed of the bit. Match the bit speed rating with the AMP rating of the motor speed.
- Never leave the drill running unattended.
- Never operate this saw under the influence of drugs, alcohol or when taking medications that impair the senses or reactions, or when excessively tired or under stress.
- Do not lend or rent this equipment without including the Operator's Instruction Manual and the Engine Manufacturer's Manual.
- Make sure all safety decals can be clearly read and understood. Replace damaged or missing decals immediately.



**Dry cutting creates a large volume of airborne dust. For health reasons, the operator should wear an applicable respirator. The dust may contain chemicals known to cause serious illnesses, including Silicosis - a fatal disease of the lungs. Check the chemical properties of the material to be cut and follow all EPA/OSHA regulations.**

## SAFETY ALERT SYMBOL



This safety alert symbol is used to attract your attention! **PERSONAL SAFETY IS INVOLVED!** When you see this symbol - **PAY EXTRA ATTENTION, BECOME ALERT, BE SURE TO HEED ITS MESSAGE.** Failure to do so may lead to serious personal injury or damage may occur.

Safety warnings and guidelines do not by themselves eliminate danger.

They are not substitutes for proper accident prevention procedures and good judgement.

# Securing Instructions

## *Bolt Down Connection*

1. To bolt down to concrete, install a concrete anchor.
2. Insert Anchor Bolt through slot in center of base, using larger washer, tighten securely.
3. Turn leveling jack until machine is level.

## *Ceiling Jack Brace*

1. Turn leveling jack down until rig is level.
2. Use pipe or wood to brace rig between overhead structure and ceiling jack.
3. Tighten Ceiling Jack against the pipe or wood.

## *Securing by Vacuum*

1. Vacuum base, vacuum pump, and connecting hardware required as listed on assembly drawing.
2. Turn on the vacuum pump at control box.
3. Turn leveling Jacks down until machine is level.
  - Note: The vacuum gasket must be in contact with the surface of the concrete.
  - Note: 15 Inches of Mercury (Hg) should be maintained before drilling operation starts.

## *Vacuum Equipment Required*

1. Install Vacuum Gasket in the groove position on the bottom of the vacuum base. Note: No glue or adhesive is required between gasket and base.
2. Place the anchor into slot in the vacuum base with anchor slot gasket between them.
3. Plug vacuum pump male straight bladed electrical connection into the electrical control box.

# Drilling Instructions

1. Screw desired diamond bit onto drill motor.
2. Connect water supply hose, turn on water valve.
3. Activate drill motor by turning the switch located on the electrical control box to "ON" position.
4. "Rule of Thumb" - Use "high speed" on drill motor when drilling 4" diameter holes or less. Use "low speed" when drilling holes over 4" diameter.
5. When drill bit reaches surface - Feed extremely slow until the drill bit has formed a complete circular groove in the concrete.
6. Drill hole by keeping amp meter gauge below maximum rating of the drill motor.
7. After hole is drilled - Keep drill motor running while backing drill bit out of hole.
8. Turn drill motor off - Then turn water off. Remove core from drill bit.
  - Note: When not in use remove drill bit from drill motor to prevent rust from forming and "freezing" between drill bit and drill motor mounting threads.

# Preventive Maintenance Instructions

EDCO Core Drill like any machine, with moving parts, as a preventative measure, should be cared for in the following manner to insure its maximum working condition.

1. Motors - Supplied and warranted by motor manufacturer - listing of service centers nearest you will be supplied with each motor or can be located in your local yellow pages.
2. Vacuum Pumps - Supplied and warranted by vacuum pump manufacturer. Listing of service centers located nearest you supplied in the instruction packet.
3. Vacuum Base - Rubber gasket tends to be abused when moving the Core Drill. You should tilt the unit back far enough, so that the wheels will touch the ground. The gasket should be checked periodically and replaced as needed. Gasket material is made from a "closed cell" foam rubber stripping and can be purchased from your local hardware store or ordered from EDCO. 3M brand super weather strip adhesive (3M part no. 051135-08001) is used to attach the gasket ends together. Available at your local hardware store or can be ordered from EDCO.
4. Column - Has a special lubricant to prevent rust. A light coat of oil is recommended to improve performance and extend the life of the lubricant.
5. Carriage - (Refer to illustration on next page) - When carriage lock (#41) is loosened, the carriage should move freely in an up and down mode only. Side to side play (Handle side to electric control box side) or back to front play (Motor to operator) must be adjusted out periodically as wear dictates by adjusting the corresponding brass wear strips (#50, 51). The brass wear strips (#48) (Motor side of carriage) and (Electric box side of carriage) are fixed and not adjustable. To adjust side to side clearance, locate item (#52) 1/4" Allen Head set screws on the handle side of the carriage; using a 1/8" Allen Head Wrench adjust all 4 set screws evenly snug then back off tension 1/8 to 1/4 turn, test and readjust if needed. To adjust back to front clearance, locate item (#52) 1/4" Allen Head set screws located top and bottom on either side of the column rack on the operator side of the carriage. Using a left and right set screws evenly until snug then back off tension 1/8 to 1/4 turn, test and readjust if needed. Other and may require varying degrees of adjustment according to use. Note: Adjustments to the wear strips can be minimized through preventative maintenance. Regular cleaning followed by a light application of oil or silicon spray on the entire column.
6. Ceiling Jack - Keep lightly oiled to prevent rust.
7. Electrical Control Box - After constant use, wires may loosen. (Do not work on the electrical box unless it is unplugged from the power source.) Tighten or replace as needed.
8. General - Periodically check all bolts to insure tightness.

## SMI Dust and Silica Warning

Grinding/cutting/drilling of masonry, concrete, metal and other materials can generate dust, mists and fumes containing chemicals known to cause serious or fatal injury or illness, such as respiratory disease, cancer, birth defects or other reproductive harm. If you are unfamiliar with the risks associated with the particular process and/or material being cut or the composition of the tool being used, review the material safety data sheets and/or consult your employer, the manufacturers/suppliers, governmental agencies such as OSHA and NIOSH and other sources on hazardous materials. California and some other authorities, for instance, have published lists of substances known to cause cancer, reproductive toxicity, or other harmful effects.

Control dust, mist and fumes at the source where possible. In this regard use good work practices and follow the recommendations of the manufacturers/suppliers, OSHA/NIOSH, and occupational and trade associations. Water should be used for dust suppression when wet grinding/cutting/drilling is feasible. When the hazards from inhalation of dust, mists and fumes cannot be eliminated, the operator and any bystanders should always wear a respirator approved by NIOSH/MSHA for the material being used.

Grinding/cutting/drilling of masonry, concrete and other materials with silica in their composition may give off dust or mists containing crystalline silica. Silica is a basic component of sand, quartz, brick clay, granite and numerous other minerals and rocks. Repeated and/or substantial inhalation of airborne crystalline silica can cause serious or fatal respiratory diseases, including silicosis. In addition, California and some other authorities have listed respirable crystalline silica as a substance known to cause cancer. When grinding/cutting/drilling such materials, always follow the respiratory precautions mentioned above.

PARTS LIST - 36" Core Drill			
ITEM #	PART #	DESCRIPTION	QTY
3	97200E	Complete HD Unit w/ 15AMP Milwaukee Motor	
7	97002	15 Amp Milwaukee Motor	
10	97003	Vacuum Base	1
11	97017	Leveling Screws	4
12	97020/97021	3/4" - 10 x 2" Hex Bolt w/ 3/4" USS flat washer	2
13	97040	Column Assembly - 36"	1
14	97050	Ceiling Jack	1
15	97053	Motor Mount 1"	1
17	97051	3/8" x 3/8" Key 4" Long	2
19	10031	1/4" - 20 x 1 Socket Head Cap Screw	8
20	97012	3/8" - 16 x 2 3/4" Hex Head Bolt	2
21	97013	3/8" - 16 x 3 Hex Head Bolt	2
22	10811	3/8" Lock Washer	4
23	10810	3/8" Hex Nut	4
28	10055	3/8" - 16 x 1 Hex Head Cap Screw	1
31	97054	Wheel Base Plate	1
32	80028	6" Diameter x 2" Wheel	2
33	10009	3/4" SAE Flat Washer	4
34	10306	3/16 x 1 1/2 Cotter Pin	4
35	10356	1/2" x 13 x 1" Hex Head Bolt	1
39	97004	Carriage Base	1
40	97005	Carriage Cover	1
41	97025	Carriage Lock	1
42	97010	Pinion Gear	1
43	97024	Small Pinion Bushing	1
44	97023	Large Pinion Bushing	1
45	10312	1/2" SAE Flat Washer	1
46	97014	Retaining Ring	1
47	10602/97015	1/4" - 20 x 1 Socket Head Cap Screw with 1/4" Washer	1

**PARTS LIST - 36" Core Drill**

ITEM #	PART #	DESCRIPTION	QTY
48	97047	2 1/2" x 8 5/8" Brass Wear Strip Non-Adj Left & Rear	2
49	97016	#10-32 x 1/2" Flat Head Brass Screw	16
50	97048	2 1/2" x 8 5/8" Brass Wear Strip Adj. Right	1
51	97049	1" x 8 5/8" Brass Wear Strip Adj.	2
52	10162	1/4" - 20 x 1/2" Set Screws	8
54	97006	Electric Box	1
55	97007	Electric Box Cover	1
56	97009	Amp Meter 0-30	1
57	16189	Toggle Switch, 20 Amp	2
58	10831/97022	#10-32 x 1/2" Pan Head Screw w/ #10 Internal Tooth Lock Washer	4
59	16199	Receptacle, 15 Amp 3 Str.	1
60	16198	Receptacle, 20 Amp Twist Lock	1
61	16109	Cord 12 GA, 3 Wire 13" Long	1
63	41130	Str. Male Connector Cord 1/2" NPT	1
64	78114	Plug 3-wire Str. Blade 15 Amp	1
71	97042	Vacuum Pump Assembly (optional) Small Rig	1
72	97037	Base Gasket (optional)	1
73	97038	Anchor Slot Gasket (optional)	1
74	97008	Anchor (optional)	1
75	97035	Hose Barb 1/8" NPT x 1/4" (optional)	1
76	97056	Clear Hose 15" Long (optional)	1
77	97034	Hose Barb 1/4" NPT x 1/4" (optional)	1
80	97031	Cross 1/4" NPT (optional)	1
81	97029	Release Valve 1/4" NPT (optional)	1
82	97032	Nipple Close 1/4" NPT (optional)	1
84	97030	Vacuum Gauge (optional)	1
85	97027	Vacuum Pump (optional)	1
86	97046	Vacuum Pump Mount Plate (optional)	1
87	97016	#10-32 x 1/2" Flat Head Screw (optional)	4
88	97041	Handle	1
89	10104	Knob, Ball 1-7/8 w/ 1/2-13THD, BLK	2

# Drill Machine Illustration

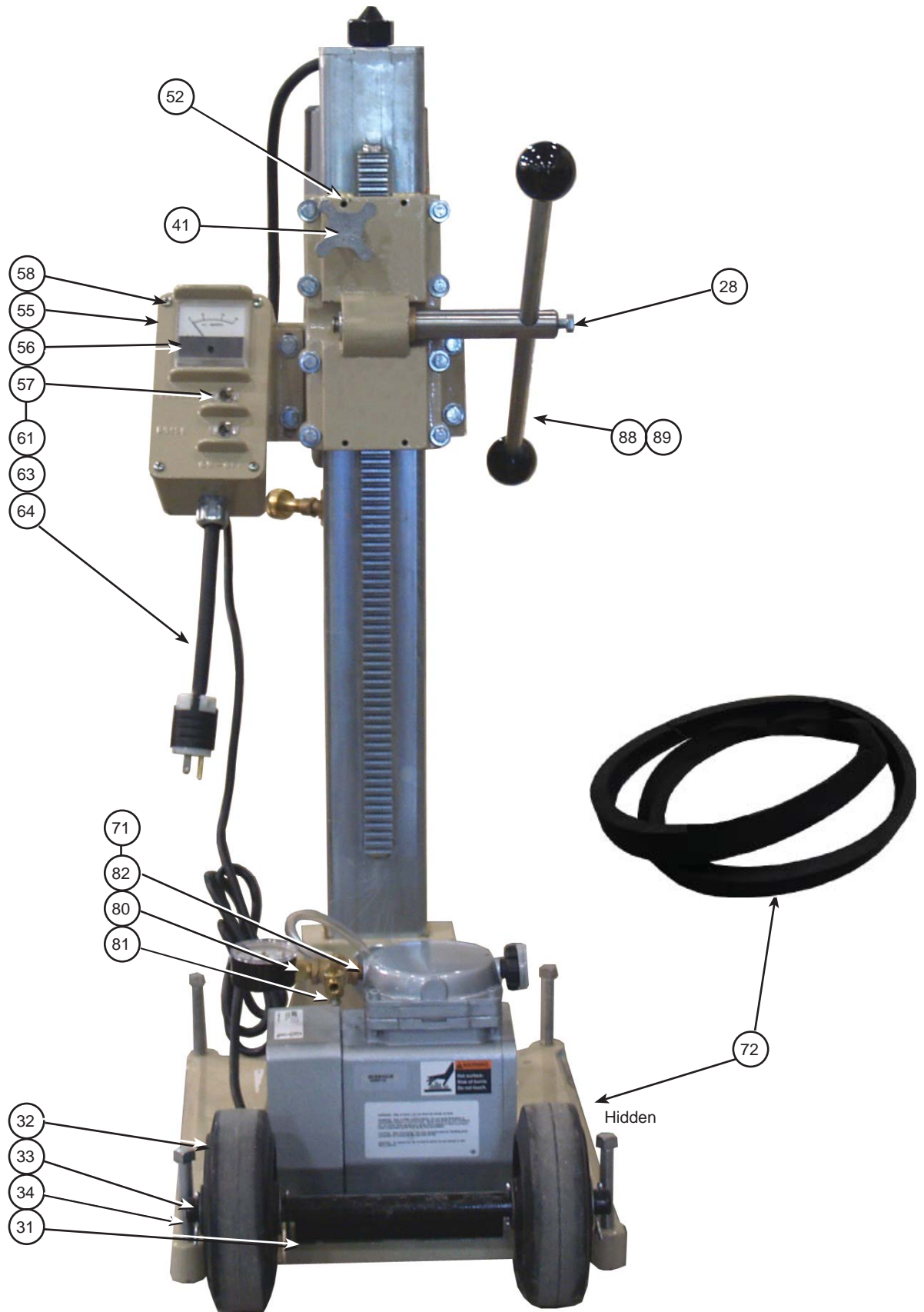

**Front View**

# Drill Machine Illustration

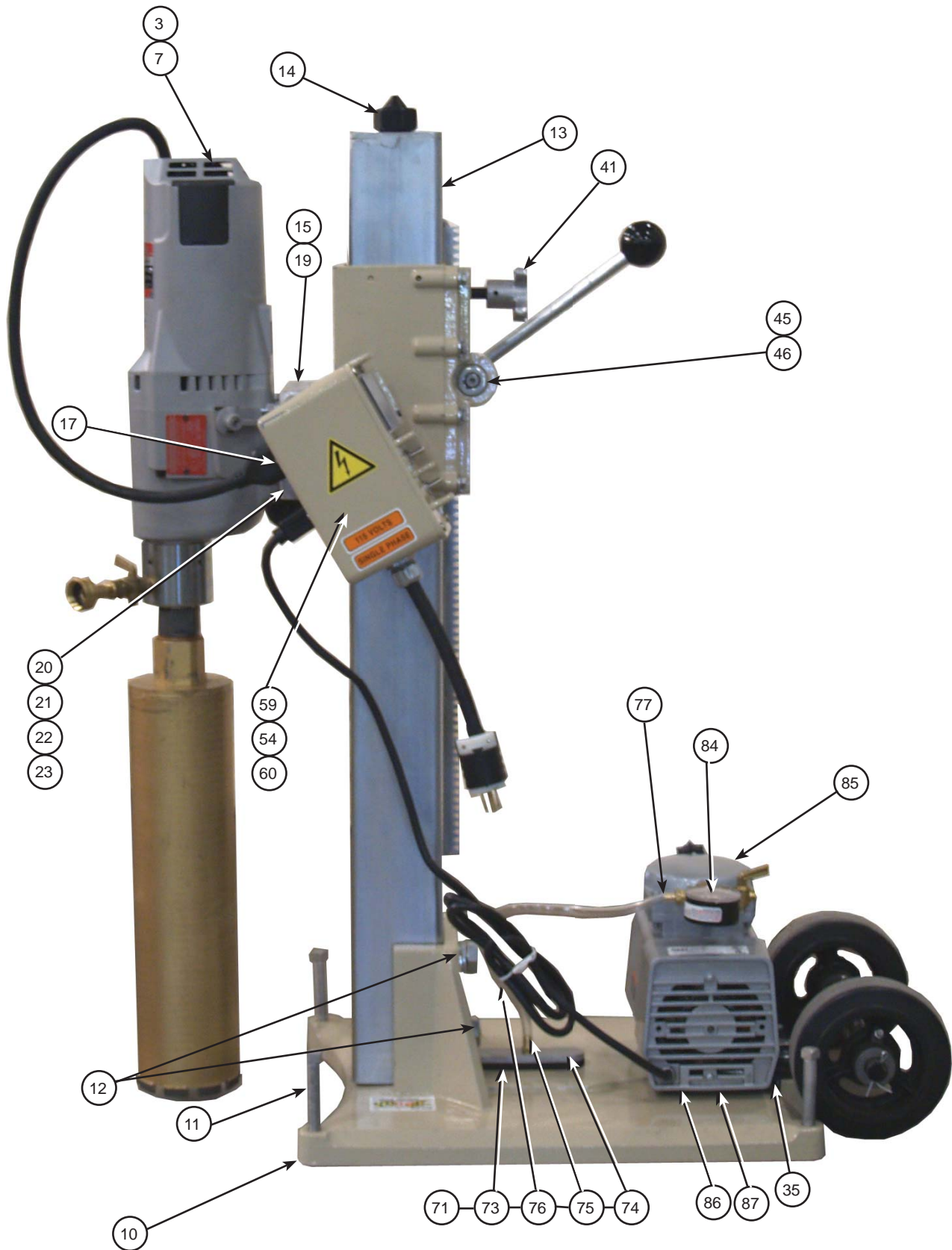

## Side View

# Carriage Assembly Illustration

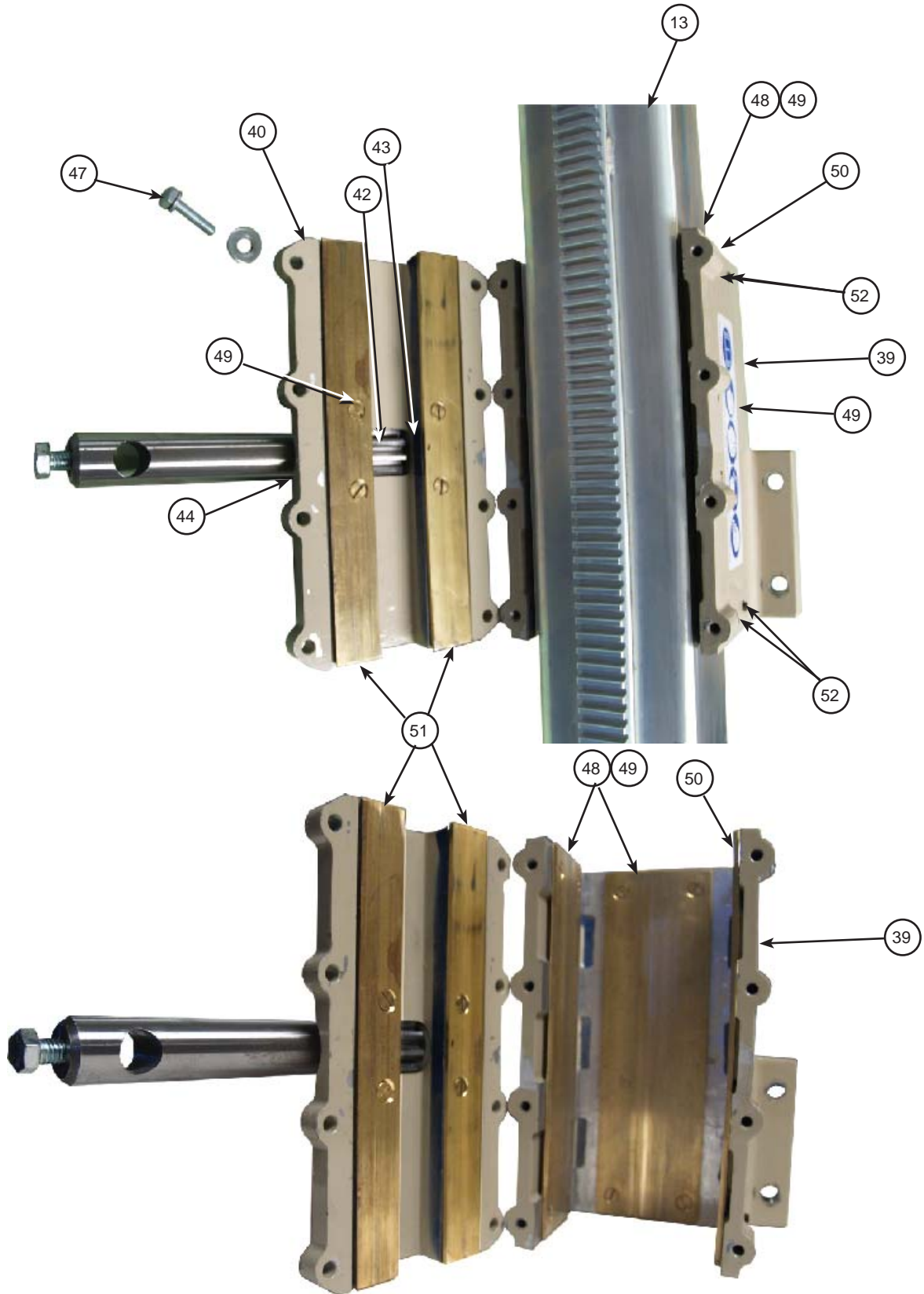

## Inside View

**LIMITED EQUIPMENT WARRANTY OF SALE – TERMS & CONDITIONS**

Equipment Development Company, Inc. herein referred to as EDCO (Seller) warrants that each new unit manufactured by EDCO to be free from defects in material and workmanship in normal use and service for a period of (90) ninety days (except for the cutter drum assembly on all model concrete/asphalt planes, in which case the warranty period shall be 90 days) from date of shipment to the original retail or equipment rental center owner.

Accessories or equipment furnished and installed on the product by EDCO but manufactured by others, including, but not limited to engines, motors, electrical components, transmissions etc., shall carry the accessory manufacturers own warranty.

EDCO will, at its option, repair or replace, at the EDCO factory or at a point designated by EDCO, any part which shall appear to the satisfaction of EDCO inspection to have been defective in material or workmanship.

EDCO reserves the right to modify, alter and improve any part or parts without incurring any obligation to replace any part or parts previously sold without such modified, altered or improved part or parts.

This warranty is in lieu of and excludes all other warranties, expressed, implied, statutory, or otherwise created under applicable law including, but not limited to the warranty of merchantability and the warranty of fitness for a particular purpose in no event shall seller or the manufacturer of the product be liable for special, incidental, or consequential damages, including loss of profits, whether or not caused by or resulting from the negligence of seller and/or the manufacturer of the product unless specifically provided herein. In addition, this warranty shall not apply to any products or portions thereof which have been subjected to abuse, misuse, improper installation, maintenance, or operation, electrical failure or abnormal conditions and to products which have been tampered with, altered, modified, repaired, reworked by anyone not approved by seller or used in any manner inconsistent with the provisions of the above or any instructions or specifications provided with or for the product

**FORCE MAJEURE**

Seller's obligation hereunder are subject to, and Seller shall not be held responsible for, any delay or failure to make delivery of all or any part of the Product due to labor difficulties, fires, casualties, accidents, acts of the elements, acts of God, transportation difficulties, delays by a common carrier, inability to obtain Product, materials or components or qualified labor sufficient to timely perform part of or all of the obligations contained in these terms and conditions, governmental regulations or actions, strikes, damage to or destruction in whole or part of manufacturing plant, riots, terrorist attacks or incidents, civil commotions, warlike conditions, flood, tidal waves, typhoon, hurricane, earthquake, lightning, explosion or any other causes, contingencies or circumstances within or without the United States not subject to the Seller's control which prevent or hinder the manufacture or delivery of the Products or make the fulfillment of these terms and conditions impracticable. In the event of the occurrence of any of the foregoing, at the option of Seller, Seller shall be excused from the performance under these Terms and Conditions, or the performance of the Seller shall be correspondingly extended.

This document sets forth the terms and conditions pursuant to which the purchaser ("Purchaser") will purchase and Equipment Development Co. Inc. ("Seller") will sell the products, accessories, attachments (collectively the Products) ordered by the Purchaser. These terms and conditions shall govern and apply to the sale of Seller's Products to Purchaser, regardless of any terms and conditions appearing on any purchase order or other forms submitted by Purchaser to Seller, or the inconsistency of any terms therein and herein.

**1. PRICE**

All prices set forth on any purchase order or other document are F.O.B. Sellers facility or distribution point, as may be determined by Seller (F.O.B. Point). All prices are exclusive of any and all taxes, including, but not limited to, excise, sales, use, property or transportation taxes related to the sale or use of the Products, now or hereafter imposed, together with all penalties and expenses. Purchaser shall be responsible for collecting and/or paying any and all such taxes, whether or not they are stated in any invoice for the Products. Unless otherwise specified herein, all prices are exclusive of inland transportation, freight, insurance and other costs and expenses relating to the shipment of the Products from the F.O.B. point to Purchaser's facility. Any prepayment by Seller of freight insurance and other costs shall be for the account of Purchaser and shall be repaid to Seller.

**2. PAYMENT TERMS**

Payment terms are as follows. 2% 10 days (to approved and qualified accounts). Net 30 days. This is a cash discount for invoices paid within 10 days after the invoice date, regardless of date of receipt of shipment. This is not a trade discount and will not be granted to accounts that do not adhere to stated terms.

\*All past due accounts are subject to a late payment fee of 1.5% per month or a maximum allowed by law if different, along with the expenses incidental to collection including reasonable attorney's fees and costs.

\*Seller reserves the right to hold shipments against past due accounts.

\*Seller reserves the right to alter payment terms.

**3. FREIGHT TERMS**

All shipments will be made F.O.B. shipping point as designated in these Terms and Conditions, and title shall pass at the F.O.B. point. Delivery to the initial common carrier shall constitute delivery to the Purchaser. Any claims for loss or damage during shipment are to be filed with carrier by the Purchaser. Seller will not assume responsibility for the performance of the carrier.

Back orders will be shipped in the most practical fashion with charges consistent with our freight policy established with the original order. UPS, FED EX, MAIL or shipments by other couriers are subject to the same terms and conditions as outlined in paragraph #3 "Freight Terms".

**4. DELIVERY, DAMAGES, SHORTAGES**

Seller shall use reasonable efforts to attempt to cause the Products to be delivered as provided for in these Terms & Conditions. Delivery to the initial common carrier shall constitute the delivery to the Purchaser. Seller's responsibility, in so far as transportation risks are concerned ceases upon the delivery of the Products in good condition to such carrier at the F.O.B. point and all the Products shall be shipped at the Purchaser's risk. Seller shall not be responsible or liable for any loss of income and/or profits, or incidental, special, consequential damages resulting from Seller's delayed performance in shipment and delivery.

**5. RETURN OF DEFECTIVE PRODUCTS**

Defective or failed material shall be held at the Purchaser's premises until authorization has been granted by Seller to return or dispose of Products. Products that are to be returned for final inspection must be returned Freight Prepaid in the most economical way. Credit will be issued for material found to be defective upon Seller's inspection based on prices at time of purchase.

**6. PRODUCTS ORDERED IN ERROR**

Products may be returned, provided that claim is made and Seller is notified within 7 days of receipt of Products, and the Products are in original buyer's possession not more than 30 days prior to return, subject to Seller's approval. If Products are accepted for return, they must be Freight Prepaid and buyer will be charged a minimum of 15% rehandling charge, plus a charge back for outbound freight charges if the original order was shipped prepaid. Returns are not accepted for any Products that are specifically manufactured to meet the buyer's requirement of either specifications or quantity.

**AGREEMENTS**

These Terms and Conditions constitute the entire agreement between Seller and Purchaser as it relates to terms and conditions of sale, and supersedes any and all prior oral or written agreements, correspondence, quotations or understandings heretofore in force between the parties relating to the subject matter hereof. There are no agreements between Seller and Purchaser with respect to the Product herein except those specifically set forth in and made part of these terms and conditions. Any additional terms, conditions and/or prices are rejected by Seller.

These terms and conditions may be modified, cancelled or rescinded only by a written agreement of both parties executed by their duly authorized agents.

**USE ONLY GENUINE EDCO PARTS & ACCESSORIES**  
**For your own safety, the safety of others and the life of your machine.**

**Equipment Development Company, Inc.**