

OCT. 1994

Model CPU-10-C DIAMOND GROOVING HEAD SYSTEM

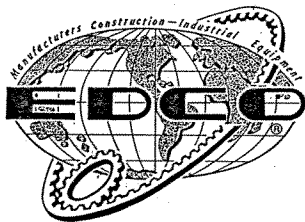
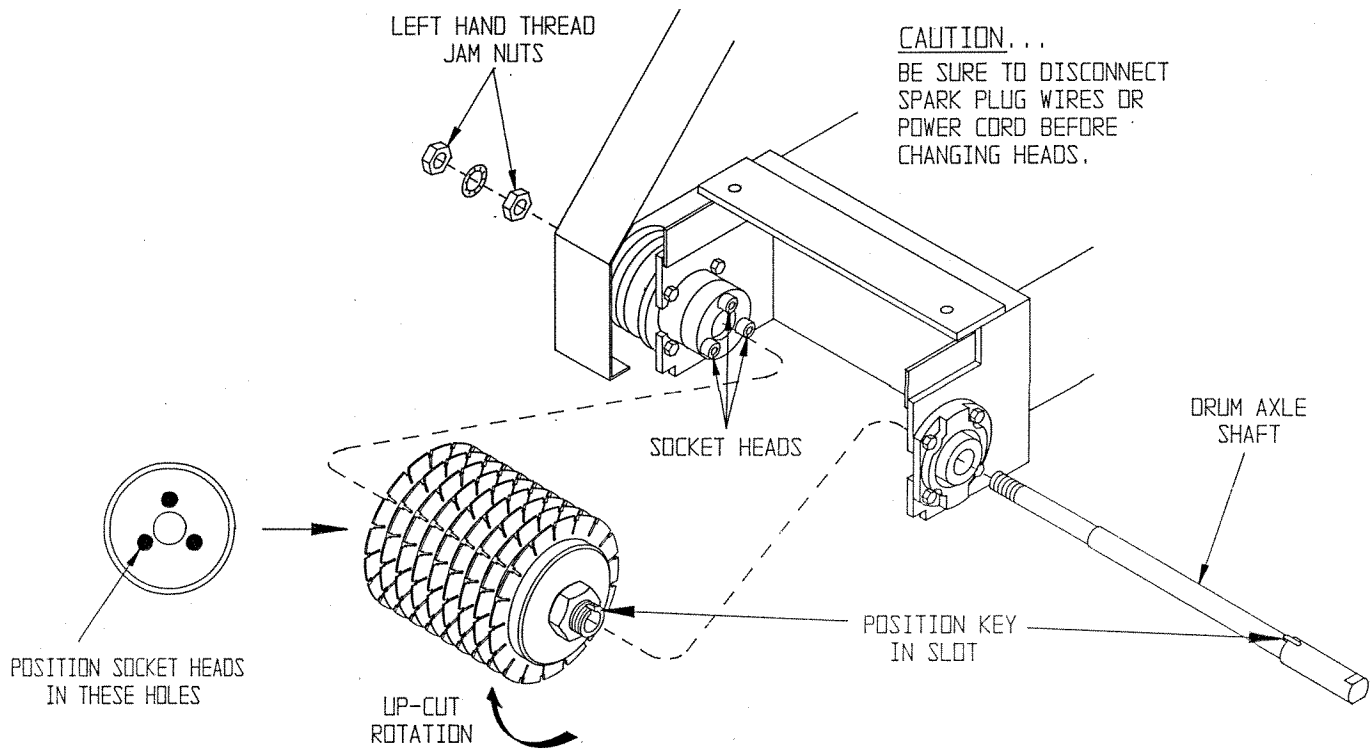

EQUIPMENT DEVELOPMENT COMPANY, INC.

100 THOMAS JOHNSON DRIVE, FREDERICK, MARYLAND 21702-4305 USA

PHONE (301) 663-1600

TOLL FREE 1-800-638-3326

FAX (301) 663-1607

FAX FREE 1-800-447-3326

PRINTED IN U.S.A.

DIAMOND GROOVING HEAD ASSEMBLY

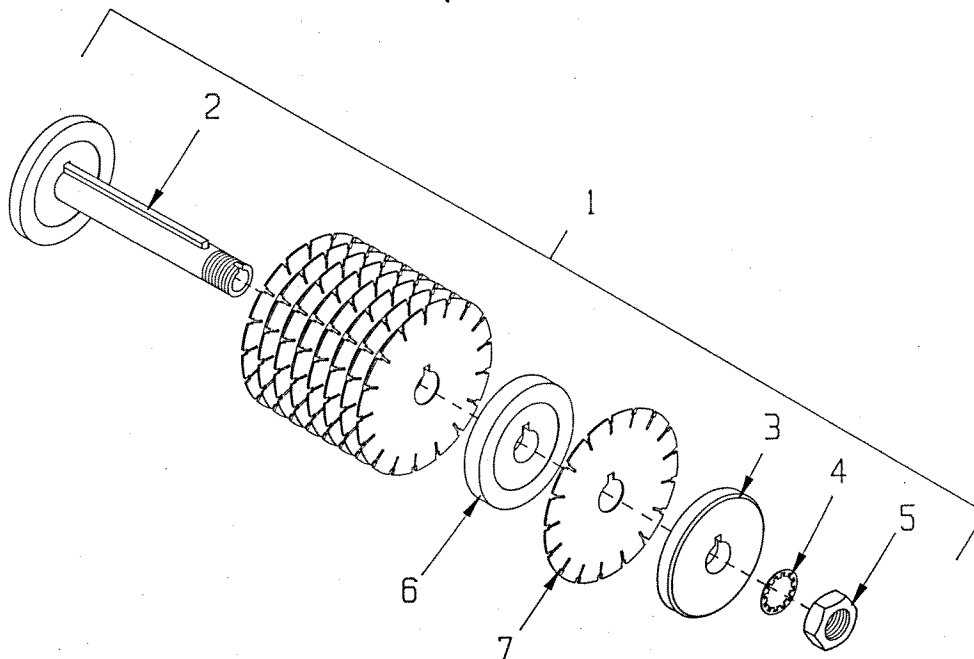

Item #	Part #	Description	Qty.
1	64301	Diamond Grooving Head Assembly (Includes Items 2 thru 5)	
2	64302	Arbor, Diamond Grooving Head	1
3	64303	Arbor Blade Retaining Cap 6"	1
4	64304	Washer, Lock, Int. Tooth 1-1/2	1
5	64305	Nut, Jam 1 1/2-12	1
6		Spacer, Blade	*
	64306	6"OD x 1-1/2"ID x .063"Thk	
	64307	6"OD x 1-1/2"ID x 1/2"Thk	
	64308	6"OD x 1-1/2"ID x 1"Thk	
7	39807	DCC-05S Diamond Blade 8"Dia. x .090"Thk. x 1.5" w/ Keyway	*

*** NOTE:**

Diamond Blades and Spacers are not included with Head Assy.
The quantities vary with the type of set-up used.

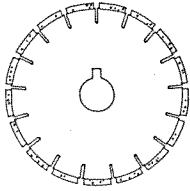

Model CPU-10-C
DIAMOND GROOVING HEAD
SET-UP

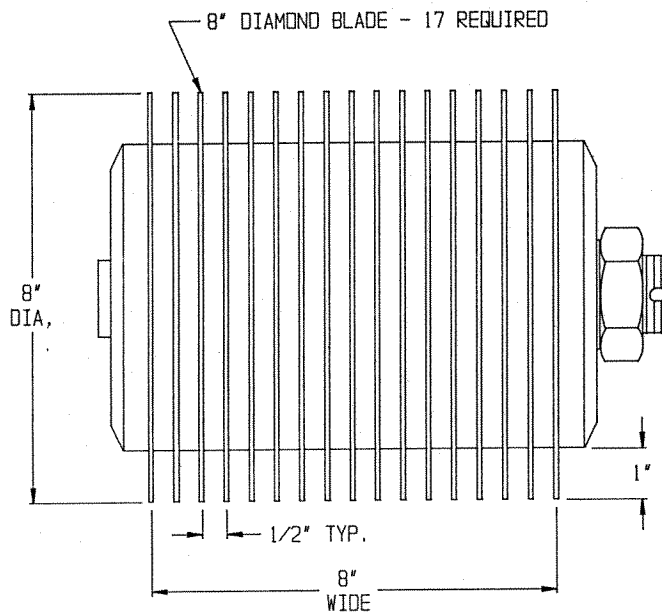
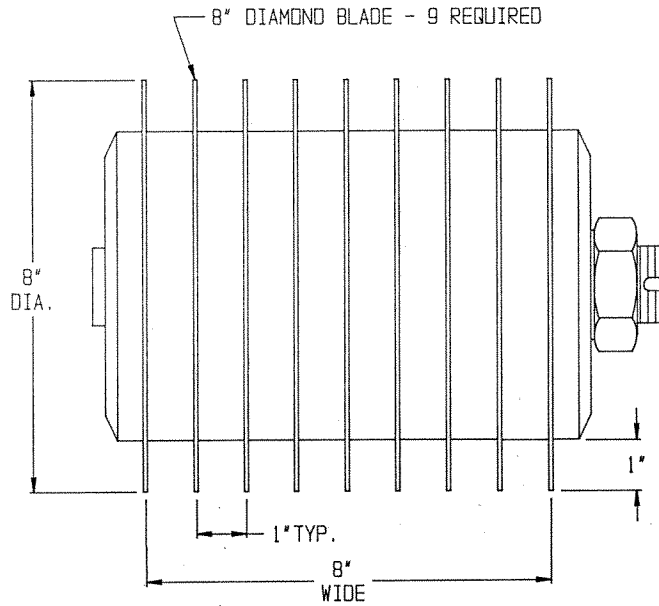
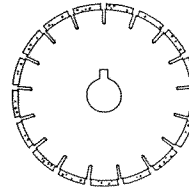

Diamond Grooving Head Installation & Operating Instructions

Mount the full grooving head system on to the planer exactly as you would a cutter drum. Three drive holes are fitted on to the socket head driver, the axle shaft is inserted into the arbor and the shaft tightened in place - using the left hand thread jam nuts.

Installing the Blades

Be sure to observe the direction of rotation arrows imprinted on each blade and on the arbor blade retaining cap. This is an "up-cut" planer and all blades should be mounted with arrows pointing in the direction of rotation. Spacers are not marked and do not require any special mounting instructions.

After the last blade has been installed - slide the arbor blade retaining cap on to the threaded end of the arbor shaft, install the lock washer and jam nut. Check to see if all blades are in place - tighten jam nut securely. Check the jam nut for tightness again after a short cut has been made. Blades must be held firmly on arbor shaft at all times.

Operating

Do not allow blades to over heat when cutting. Blade segments are laser welded and can be used to cut dry, however, we recommend that cutting is done wet whenever possible. Blade life is shortened approximately 30% when used dry.

If water fittings are not installed on the planer, allow water from a hose to run onto the slab and under the blades. Only enough water to keep surface wet and dust under control is necessary.

When cutting, allow the machine to move forward without forcing the blades into the concrete. Forward speed depends on hardness of slab and depth of cut. Cutting depth should not exceed 3/4 inch (.750 in - 20mm).

Always consult with your diamond blade supplier when ordering blades. Provide the following information - type of material to be cut (concrete, asphalt, epoxy), hardness of slab and aggregate (3500 psi - limestone, river gravel, granite, etc.), depth of cut required, wet or dry cutting and how much cutting will be done (linear feet/meters).

The grooving head set-ups shown are only examples. More or fewer blades can be used - spacers are available from .063 to 1 inch in width. Maximum width of cut is 8 inches (200mm).